

Precision Measurement DIGITAL S-LINE CALIPER

Thank you for purchasing the DIGITAL S-LINE CALIPER. This caliper is IP-67 rated for water and dust resistance, and can be used in applications where it will be exposed to liquids such as water, cutting fluid, and lubricating oil.

- For safe and proper use, please read this instruction manual before use and follow the procedures described.
Please keep manual where it is accessible to user for future reference.
- Keep this manual with the instrument if transferred or leased to a third party.
- For inquiries about this product, please contact the dealer where purchased, or Niigata Seiki.

■ PARTS IDENTIFICATION ※Model D-150IP67M shown.

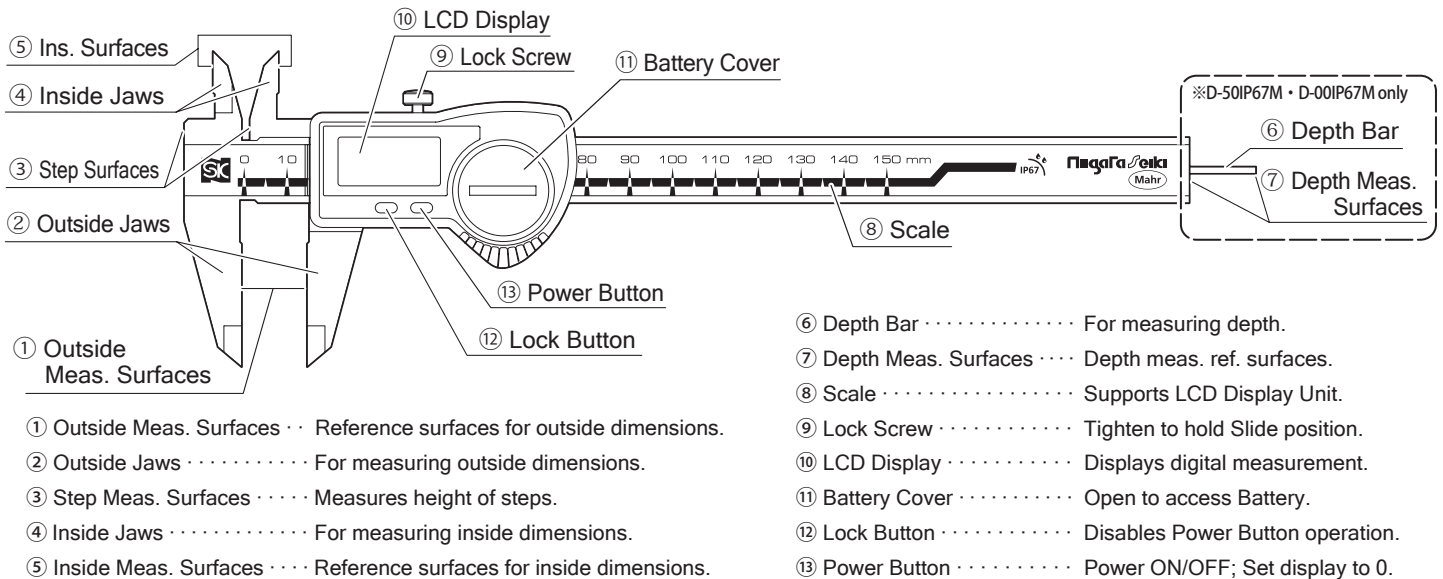

SAFETY NOTICES

Please Observe

To prevent harm to yourself or others, and to prevent damage to property, always follow the procedures marked by the following symbols.



Denotes a prohibition
- You **MUST NOT** do.



Denotes a requirement
- You **MUST** do.



WARNING: Indicates risk of **personal injury** or **property damage** if not followed.



Read the manual and follow the directions.

- Use of product other than as described in this manual may cause accident.



Use only for measuring.

- Use for any purpose other than measuring may damage or wear the instrument. Improper use may also cause accident.



Handle with Care.

- Do not drop or subject instrument to excessive shock. Do not place under heavy objects. Improper handling may cause damage or poor accuracy.
- Do not scratch instrument surfaces.



Use and store only in environment meeting the following conditions:

- Dry and protected from rain, water, and oils.
- Protected from direct sunlight.
- Location that is not excessively hot.
- Not subject strong electric or magnetic fields.
- Protected from children and unauthorized users.

- Use in places contrary to the above may cause damage to the product or affect accuracy resulting in accident or injury.



After use, apply corrosion inhibitor and store in location protected from direct sunlight.

- Always apply rust protection after use.



Jaw Tips Are Sharp – Handle With Care.

- Careless handling may cause injury.



Do not disassemble or modify.

- Disassembly may damage product or cause accident. For repair, please contact distributor or place of purchase.



Do not write on instrument with electric engraver.

- Do not engrave instrument Scale, or Jaws such as an ID number with engraver or electric pen.



Do not clean Slide or main body with organic solvents.

- It may damage product and affect accuracy.

To maintain instrument accuracy, periodic calibration is recommended.

Calibration interval necessary to maintain accuracy will vary depending on frequency and conditions of use. Please follow your companies guidelines and calibrate regularly.

Outside Japan,
Please contact distributor or place of purchase to inquire about calibration services.

BATTERY

- ① Rotate the Battery Cover using the supplied tool to remove.
- ② Insert the CR2032 lithium battery. Insert the Battery with the (+) side facing out.

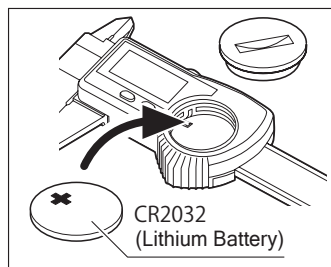
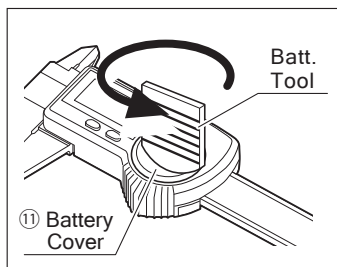

- Use only CR2032 type battery.
- Remove the insulating sheet when using for the first time.

- ③ Replace the cover using the Battery Tool.

TROUBLESHOOTING

ERROR	CORRECTIVE ACTION
「Error」 message is displayed on LCD.	Jaw has been moved to quickly. Please press the Power Button to reset.

AFTER USE CARE - STORAGE

- After use, wipe off any dirt or oil from measuring surfaces, sliding surfaces, and exterior using a dry cloth and perform rust prevention treatment. Apply light coat of corrosion inhibitor, or place in rust preventive bag.
- Store with Jaws slightly open. If stored with Jaws closed tight, expansion due to temperature changes may cause excessive force which will cause inaccuracy.
- Store in a cool, dry, and dark location in the provided case. Keep out of direct sunlight and moisture, and please keep secure from unauthorized personnel.
- Remove battery if Caliper will not be used for a long period of time.

SPECIFICATIONS

Model No.	D-150IP67M	D-200IP67M	D-300IP67M
Meas. Range	0—150mm	0—200mm	0—300mm
Resolution	0.01mm		
Maximum permissible error	±0.03mm		±0.04mm
Max. Rsp. Speed	2.5m/s		
Mass	150g	200g	280g
Depth Bar	Yes		No
Waterprf Rating	IP67		
Op. Temp. Range	10~40°C		
Power	CR2032 (Lithium Battery)		
Accessories	<ul style="list-style-type: none"> • Inst. Manual • Battery Cover Tool • Case • CR2032(Lithium Battery) ※ For test 		

SERVICE

- If Instrument is not working properly, or if you have any questions, please contact distributor or place of purchase.
- Please note, manufacturer is unable to respond to inquires or provide service directly. Please contact distributor or place of purchase.

HOW TO USE

Press...Press and release (< 1 sec.)
Long Press...Press and hold (> 1 sec.)

Power ON/OFF

With the Lock Screw loose, press the Power Button or move the Slide to turn the power ON. A long press of the Power Button will turn power OFF.

※ When OFF, the display is off, but the previous state will be saved. When turned ON again, gauge will return to prior state.

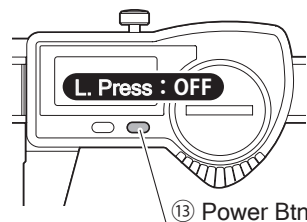

Power will automatically turn OFF after about 8 minutes with no activity.

Press the Power Button or move the Slide to turn ON. The 『 』 icon will display when the battery level is low. Please replace the battery.

Absolute Measurement Mode

With the jaw completely closed, press the Power Button. "0.00 mm" will be displayed and instrument is ready for measurement.

Comparative Measurement Mode

Set the Jaws to the desired reference position and press the Power Button. "0.00 mm" will be displayed and instrument is ready for measurement.

Button Lock

Press the Lock Button.

A lock icon will be displayed on the LCD, and the Power Button is disabled. Press the Lock Button again to unlock.

Data Output

With Optional Data Cable, the measurement data can be output.

Remove the cover on the Data Output Connector, and attach the dedicated cord.

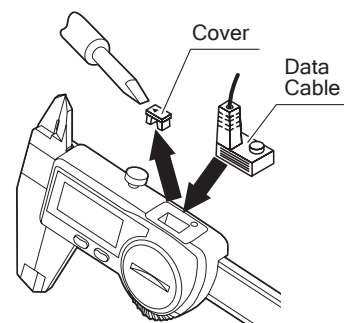

- Please refer to the SK-LOG Instruction Manual for data communication details.

IP CODE SUMMARY

IP rating for electrical equipment defined by IEC standard for water and solid body protection.

I P 6 7

2nd Digit : Water proof rating

1st Digit : Protection rating for ingress of solid object

1 st Digit	Description	Degree of Protection	Test Method
6	Solid Ingress Protection	No ingress of dust allowed. Dust tight.	Complete protection from dust intrusion
2 nd Digit	Description	Degree of Protection	Test Method
7	Liquid Ingress Protection	No harmful effect when immersed in water for specified period and pressure.	Submersion for 30min. at depth of 1m (for devices of height less than 850mm)

SK Niigata Seiki Co., Ltd.

5-3-14, Tsukanome, Sanjo, Niigata, Japan, 955-0055
Tel. : +81-256-33-5522 Fax. : +81-256-33-5518
MAIL intl.sales@niigataseiki.co.jp
URL http://www.niigataseiki.co.jp