

BORESCOPE WITH MONITOR MIS-5510G

⚠ NOTICE

When the Camera Cable is connected to Main Unit, **do not pull or bend at tight angle.**

Pulling on Cable may damage internal wires.

Use the following procedure to attach and remove the Camera Cable from the Main Unit.

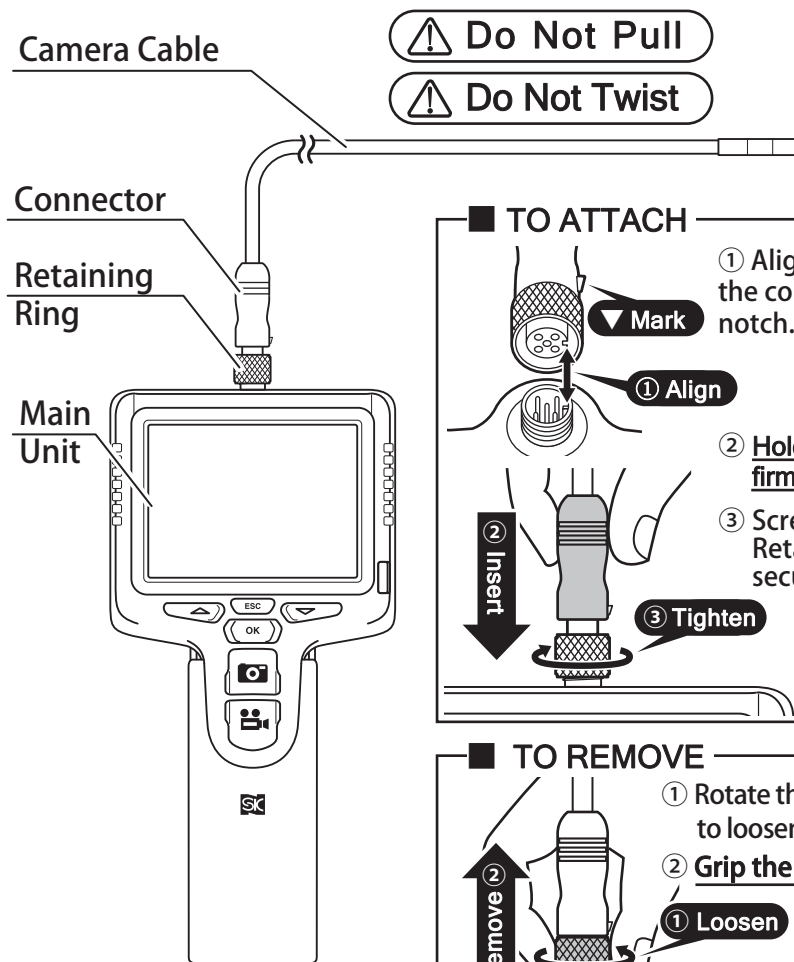

■ TO ATTACH

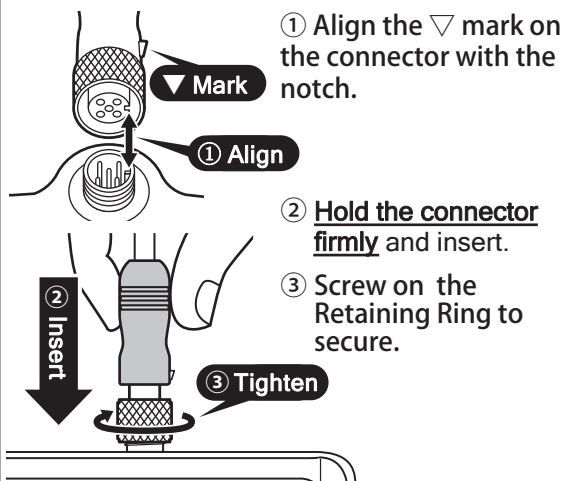

■ TO REMOVE

