

4X INTERCHANGEABLE LENS Instruction Manual

SL-4

■ 4X Replacement Lens for LED Magnifier.

Thank you for purchasing the SL-4 4X Interchangeable Lens.
Please read this manual thoroughly before use to insure proper operation and long service.

■ BEFORE USE

◆ For safe and correct operation, please read the following carefully

⚠ WARNING

- To prevent risk of electrical shock, turn off power to LED Magnifier before replacing lens.
- Never look at sun or bright light through the lens. There is risk of damage to eyesight.
- Do not expose lens to sunlight or intense light, there is risk of starting fire.
- To prevent risk of fire, never leave lens in location where it can be exposed to direct or reflected sunlight.
- Keep lens away from children.

⚠ NOTES

- Glass lens is resistant to scratching, but can be chipped or broken by mishandling. Please use care when moving or installing lens to avoid impact or dropping of lens. Mishandling may cause scratches or injury.
- Do not place the lens in water or rinse with water to clean. Water may enter lens and cause mold growth or cloudiness.
- Keep product away from ozone producing electrical devices, direct sunlight, rapid temperature changes or extreme temperatures during use and storage. Lens damage or deformation may result.
- Please keep lens clean of dust and fingerprints.
- Clean lens gently with lens cloth or soft cloth. Do not wash with abrasive cleaners, or rinse with water.

■ SPECIFICATIONS

Model	Lens Material	Viewable Area	Magnification	Weight
SL-4	Hard Glass	~ φ 140mm	~ 4 x	~ 1.1 kg

Applicable Magnifier	LED ARM MAGNIFIER	LS2-175A / LS4-150A
	LED STAND MAGNIFIER	LS2-175S / LS4-150S

■ REPLACING THE LENS

- ① Remove the lens from the LED Magnifier using the procedure shown for the appropriate model magnifier.

● LS2-175A • LS2-175S

Turn the Lens Bezel as shown to loosen, and remove the lens.

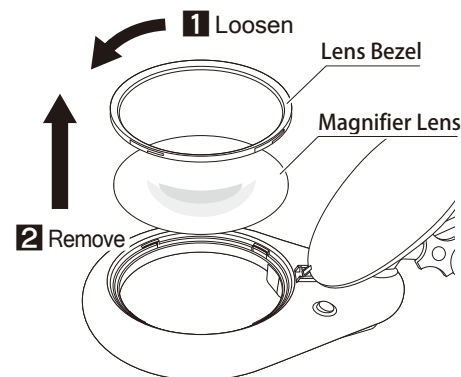

● LS4-150A • LS4-150S

Carefully push the Lens from below to remove.

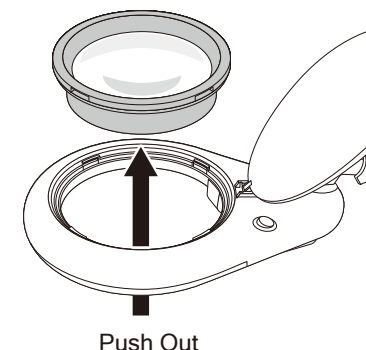

- ② Align the notches on the 4X Interchangeable Lens with the tabs on the LED Magnifier head and press in firmly to install.

※ For models LS2-175A • LS2-175S, the Lens Bezel is not used when the 4x Interchangeable Lens is installed.

- ③ After installation, check to insure there is no gap and Lens is firmly seated in housing.

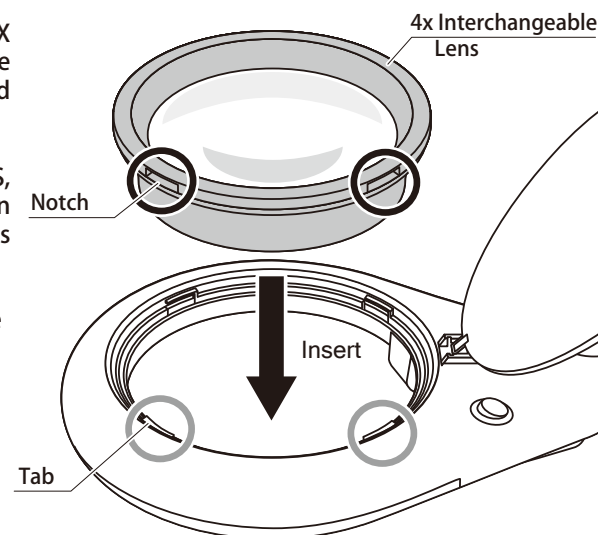

Niigata Seiki Co., Ltd.

5-3-14, Tsukanome, Sanjo, Niigata, Japan, 955-0055
 ☎ +81-256-33-5522 FAX: +81-256-33-5518
 MAIL: intl.sales@niigataseiki.co.jp
 URL: <http://www.niigataseiki.co.jp>
 E1041-Q1 1811100

※ Please note: Product improvement may result in changes to specifications and appearance.